

## 62 Rosehill Road, Rhyl, Denbighshire LL18 4TR

£210,000

2 1 1



This well maintained two bedroom bungalow set in a sought after location could be described as 'ready to walk into' and has been tastefully modernized and decorated by its present owner. The property benefits by way of gas central heating, uPVC double glazing, large lounge/diner, two double bedrooms, modern kitchen diner with built-in appliances. The town of Rhyl with its shops and public amenities is close by and there are good links to the A55 expressway for travel to Colwyn bay, Llandudno and Chester. With gardens front and rear, ample off road parking and a single detached garage early viewing is highly recommended.

## Key Features

- DETACHED BUNGALOW
- TWO DOUBLE BEDROOMS
- LARGE LOUNGE/DINER
- KITCHEN/DINER
- SOUGHT AFTER AREA
- GARAGE & GARDENS
- OFF ROAD PARKING
- FREEHOLD
- EPC - D
- COUNCIL TAX BAND - C

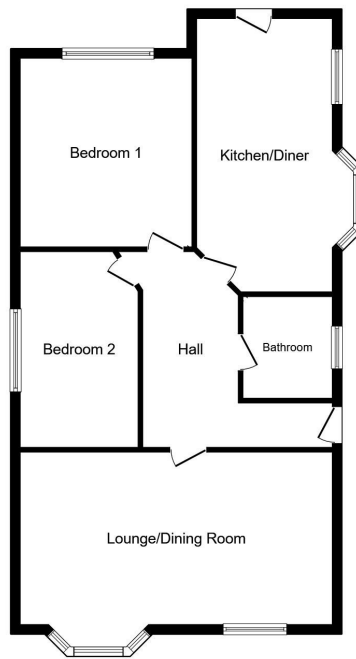

Floor Plan

TOTAL: 86.7 m<sup>2</sup> (933 sq.ft.)

This floor plan is for illustrative purposes only. It is not drawn to scale. Any measurements, floor areas (including any total floor area), openings and orientations are approximate. No details are guaranteed, they cannot be relied upon for any purpose and do not form any part of any agreement. No liability is taken for any error, omission or misstatement. A party must rely upon its own inspection(s). Powered by [www.Propertybox.io](http://www.Propertybox.io)